



DocuPrint C2428

Colour Laser Printer

THE DOCUMENT COMPANY
FUJI XEROX



DocuPrint C2428

Colour Laser Printer

Media and Supplies

Fuji Xerox Printers Printing Media

Premium Colour Printing Paper
500 sheets, 90gsm bond
A4 (210 x 297 mm) 016-1369-00
A3 (297 x 420 mm) 16-1700-00

Premium Cover Paper
100 sheets, 160gsm cover
A4 (210 x 297 mm) 016-1824-00

Premium Coated Cover Paper
100 sheets, 216gsm cover
A3 (297 x 420 mm) 016-1964-00

Glossy Coated Paper
100 sheets, 148gsm text
A4 (210 x 297 mm) 016-1705-00
50 sheets, 148gsm text
A3 (297 x 420 mm) 016-1719-00

Premium Transparency Film
50 sheets
A4 (210 x 297 mm) 016-1951-00

Colour Laser Labels
100 sheets, 176gsm label
A4 8/sheet 016-1689-00

Consumables

Standard Capacity Toner Cartridges
Cyan (up to 6000 pages) CT200380
Magenta (up to 6000 pages) CT200382
Yellow (up to 6000 pages) CT200384
Black (up to 7500 pages) CT200378

High Capacity Toner Cartridges
Cyan (up to 12,000 pages) CT200381
Magenta (up to 12,000 pages) CT200383
Yellow (up to 12,000 pages) CT200385
Black (up to 15,000 pages) CT200379

Additional Supplies

Drum Cartridge (up to 30,000 pages) CT350270
Waste Toner Bottle (up to 25,000 pages) CWAA0521

Capacities are based on 5% coverage on an A4 size page

Accessories

Internal Hard Disk (20GB) EL300341
Duplex Unit EL300335
500 sheet feeder EL300333
1500 sheet feeder EL300334
Face up Tray EL300336
Banner Tray BL300342
PostScript Software Kit EL300337
USB2.0 Kit EL300339
Media Print Kit EL300340
Contents Bridge Extension Kit EL300338

Additional memory
256MB Memory BL300343
512MB Memory EL300344

Configurations

	C2428N	C2428DN	C2428DT
Performance			
Print speed	24ppm colour and black		
Print speed duplex	20ppm colour and black		
First page out	12 secs colour; 10 secs black		
Memory (Std / Max)	128/512 MB RAM	256/512MB RAM	256/512MB RAM
Processor	Power PC 603e-350MHz, PCL 6, PCL 5e, PCL 5c, HP-GL and HP-GL2		
Internal hard disk drive	20GB (Optional)		
Maximum Duty Cycle	Up to 80,000 pages/month		
Print Quality			
Print resolution	600/1200dpi		
Networking			
Network connectivity	Ethernet 100BASE-TX/10BASE-T, IEEE 1284, USB1.1, USB2.0 (Optional)		
Paper Handling			
Automatic 2-sided printing			Standard
Paper input capability	500-sheet universal tray, 150-sheet multi-purpose tray		
			Additional 500-sheet feeder
Paper output capability	500-sheet standard tray face down; 150-sheets side tray face up		
Productivity			
Standard Features	Banner printing, PDF direct print, Poster and Stamp (watermark) printing, Email printing, IP address restriction, control panel restriction and ID Printing, CentreWare utilities		
	Booklet printing		
Warranty			
	One year on-site warranty		

Specifications

Network/Software

Printer management CentreWare IS Embedded Web Server (EWS).

Font capabilities Standard Europe 80 fonts, Optional PS 136 fonts.

Printer drivers Windows 95/98/Me, Windows NT 4.0, Windows 2000, Windows XP, Windows Server 2003, (Optional PostScript required for Mac OS 8.6 – 9.2.2 Mac OS X 10.1.5/10.2.).

Languages PCL 6, PCL 5e, PCL 5c, HP-GL and HP-GL2 (Adobe PostScript – Optional).

Paper Handling

Media types Standard tray: plain/recycled paper (60-80gsm), bond paper (81 - 105gsm), heavy weight paper 1 (60 - 135gsm), heavy weight paper 2 (170 - 216gsm), transparencies. Optional Tray: plain/recycled paper (60 - 80gsm), bond paper (81 - 105gsm), heavy weight paper 1 (60 - 135gsm) Bypass tray: plain/recycled paper (60 - 80gsm), bond paper (81 - 105gsm), heavy weight paper 1 (60 - 135gsm), heavy weight paper 2 (170 - 216gsm), transparencies, labels, envelopes, cards.

Media sizes Standard tray: A3, A4, B4, B5, 11 x 17", Legal, Letter, Envelope, Custom size (W: 182-297mm, L: 148-432mm) Bypass tray: A3, A4, B4, A5, B6, A6, 11 x 17", Legal, Letter, Envelope, Long size (305-1200mm), Custom size (W: 90-305mm, L: 98-1200mm)*2, Duplex print*5: A3, A4, B4, B5, A5, 11 x 17", Legal, Letter.

Special features

Productivity tools Secure Print, Energy save mode, booklet printing*1, watermarks, banner printing, digital camera direct print*3, original direct print*3, media print*3, PDF direct print, sample/security/form overlay printing*4, IP address restriction, control panel restriction and ID printing.

Colour controls

Print quality modes Standard, High Quality, High resolution (1200dpi).

Colour correction modes Image auto correction (default), portrait, landscape, map.

Image types Normal, Photo, Presentation, Web pages, POP, sRGB, IS330, KODAK_DC.

Operating

Dimensions: Width: 678mm, Height: 473mm, Depth: 631mm, Weight: 59.4kg.

Environment: Temperature: 5 to 32°C, Relative Humidity: 15 to 35%, Noise levels: Standby mode; 4 to 25db (A) Running mode; 6.3db (A) to 51db (A).

Electrical: 220-240 VAC, 50/60 Hz, Consumption: 400 W avg./ 999 W max. Save mode: 5 W, ENERGYSTAR[®] qualified printer.

Customer Support

One-year on-site warranty, online web technical support and telephone support. Innovative service offerings include optional extended Service Agreements and custom training for your internal Help Desk.

*1 requires optional duplex option

*2 requires 256 MB or more

*3 requires optional media kit

*4 requires optional hard disk drive



Affordable,
faster and
brilliant
colours.

For more information or for your nearest authorised Fuji Xerox Printers reseller, visit our web site or call:

www.XeroxPrinters.com.au

Australia 1300 7XEROX
New Zealand 0800 9XEROX



©2003 Fuji Xerox Printers. All rights reserved. Contents of this publication may not be reproduced without permission of Fuji Xerox Printers. Xerox, The Document Company, the stylised X, Phaser, CentreWare[®] and PhaserSmart[™] are registered trademark/trademarks of Xerox Corporation. All other names mentioned are trademarks of their respective companies. The information in this brochure is subject to change without notice. FXP_2428_MarsDesign_02/04



THE DOCUMENT COMPANY
FUJI XEROX

Fuji Xerox Printers...**EASY!**

Have an edge over your competitors. The DocuPrint C2428 Colour Laser Printer is designed to help you do just that with speed, image accuracy, higher resolution and better cost-efficiency. In fact, the DocuPrint C2428 prints both black & white and colour without any compromise in speed! So why just keep up? Speed up your performance and stay ahead with our cutting edge technology today.

DocuPrint C2428

A3 Colour Laser Printer

Increase your productivity and enjoy high quality prints and value at the same time.

Higher speed, reliability and value

The DocuPrint C2428 has the fastest print speed in its class: 24ppm at true 1200dpi resolution. It features a newly developed Intelligent Imaging and unique multi-level acceleration technology that enables high speed printing at maximum resolution. This means documents, including fine text and line drawings can be printed at optimum quality without compromising the print speed.

Shorter warm-up time

Combining Fuji Xerox unique energy-saving "Free Belt Nip Fuser" and a newly developed "4-2-1 tandem engine" allows image quality adjustment and fuser preheating to take place concurrently at startup. In addition, four colours of density control patterns are written at high speed and then read together, enabling a short warm-up time from power-on or sleep mode of less than 30 seconds.

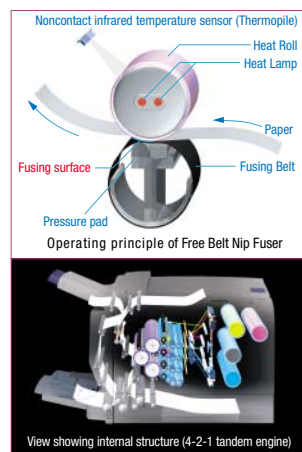

Uncompromised reliability with new Fuji Xerox technology

A thermopile infrared temperature sensor is incorporated, allowing high reliability, high temperature control accuracy and superior output quality for all input media.

Faster data processing

The DocuPrint C2428 comes with a 350 MHz Power PC 603e in its CPU and uses a high-speed 32 bits/66 MHz PCI bus, allowing a large volume of data processing. The DocuPrint C2428 allows a maximum of 640 MB RAM for print data spooling.



24ppm colour printing at maximum resolution without reduction in speed

The DocuPrint C2428 features a low-profile spray paint lower assembly with a small polygon mirror. This allows excellent print quality that only this technology can achieve. With this ROS, the DocuPrint C2428 can print 24ppm at maximum resolution.

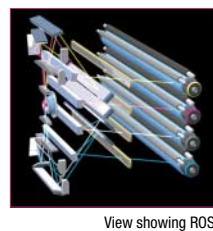

True 1200dpi resolution and multi-level resolution of 600dpi

The DocuPrint C2428 is perfect for high-speed printing of photos and line drawings. It has three print modes. In the Normal or High mode, it can produce multi-level prints with excellent gradation at a resolution of 9600dpi x 600dpi. In the Superfine mode, it delivers sharp high definition prints at 24ppm at a resolution of 1200dpi x 1200dpi.

New EA toner that delivers high quality prints for all media

The oil-free EA toner enhances the clarity of monochrome characters in office documents and reduces glossiness of photos and graphics, achieving vivid and natural colour imaging. You can also annotate printed documents with a ballpoint pen, apply a stamp, or put a Post-it. The DocuPrint C2428 also allows high-quality prints to be made on recycled paper. Thus, versatility of media selection in the office is expanded.

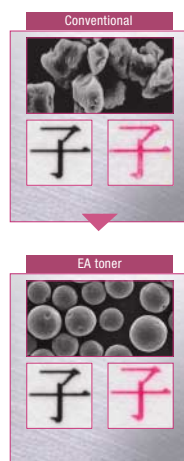

Innovative features that give you more

There's more than meets the eye with the DocuPrint C2428. It is an extraordinary colour printer that comes with a host of innovative and useful features to help you do more. Like direct printing from digital cameras, long format printing for banners, e-mail printing and secure printing. So you enjoy improved efficiency and higher productivity with its versatility.

Direct printing from digital camera and PDF files without using a PC

By installing an optional media print kit, image data recorded with a digital camera or a document file via a compact flash card or memory stick can be printed directly without using a PC. There is also versatility of digital camera images printed in an index format (24 images on A4 paper) or with images selected (three images on A4). While a PDF file selected from the files stored in the media can be printed with a number of copies and print modes (simplex/duplex printing) specified. PDF files in a laptop can be printed directly without installing any printer driver.

Print your own banner

The DocuPrint C2428 allows you to print your own banner of up to 305mm x 1200mm. Various applications such as PowerPoint and Excel can also be used to create visually appealing banners or point-of-purchase materials. And with the help of the DocuPrint C2428, you save time and money with your own in-house printing.



Secure printing

Confidential print jobs can be stored in the DocuPrint C2428 temporarily and printed safely later by operating the control panel of the printer.



DocuPrint C2428

Colour Laser Printer

Lower cost for all-round affordability and value

The DocuPrint C2428 isn't just great in performance but also gives you all-round affordability. Its advanced technology means lower maintenance costs as well as substantial savings in power consumption. Which means you get to enjoy better performance with greater affordability and value.

Low power consumption

The newly developed power management device has reduced the maximum power consumption. The power consumption in the sleep mode is the lowest in its class. This low energy design also conforms to the International Energy Star Programme. The warm-up time from power-on or sleep mode is also shortened to less than 30 seconds. Select the Quick mode and the warm-up time is further cut to less than 20 seconds. So you save energy and reduce time-cost simultaneously.

Low running cost

Two types of toner cartridges are available: standard and high capacity. With the high capacity toner cartridge, you can print up to 15,000 pages in monochrome and 12,000 in colour. This helps to reduce maintenance and running cost. At the same time, it gives you more value.

